

NOTES:

1. SILT FENCE & CONSTRUCTION ENTRANCE SHALL BE INSTALLED & INSPECTED BY LOCAL ENGINEERING DEPARTMENT PRIOR TO COMMENCEMENT OF ANY OTHER WORK.
2. ALL NON-PAVED DISTURBED AREAS TO BE RESPAVED WITH 6-INCHES TOPSOIL AND ESTABLISHED WITH VEGETATIVE OVER.
3. ALL SPOT ELEVATIONS ARE TO TOP OF PAVEMENT UNLESS OTHERWISE NOTED.
4. ALL PROPOSED GRADES AT THE PROPERTY LINE ARE TO MEET/MATCH EXISTING GRADES.

5. THE CONTOURS & SPOT ELEVATIONS DEPICTED ON THE ROADWAY ARE TOP OF PAVEMENT ELEVATIONS. ALL OTHER CONTOURS AND SPOTS ARE TOP OF SUBGRADE.
6. REFER TO SHEET C8.0 FOR EROSION CONTROL DEVICES AND SPECIFICATIONS.
7. ALL OVERLAND FLOOD ROUTES SHALL BE STABILIZED BY SOD OR BLANKET.
8. THE CONTRACTOR SHALL PROVIDE DUST CONTROL AS REQUIRED A WATER TRUCK SHALL BE AVAILABLE ON-SITE WITHIN ONE (1) HOUR OF CITY REQUEST.
9. A LEVEL (2% GRADE OR LESS) AND CLEAR LANDING SHALL BE MAINTAINED FOR 5' OUT FROM THE ENTRANCE.

10. INSTALL CLAY BARRIER BELOW AND AROUND THE PROPOSED BASEMENT FOUNDATION. BARRIER TO BE INSTALLED TO AN ELEVATION OF 897.00. CONSTRUCTION OF CLAY LINER SHALL BE OBSERVED AND TESTED BY A QUALIFIED SOILS CONSULTANT. COORDINATE ALL CONSTRUCTION WITH THE STRUCTURAL ENGINEER.

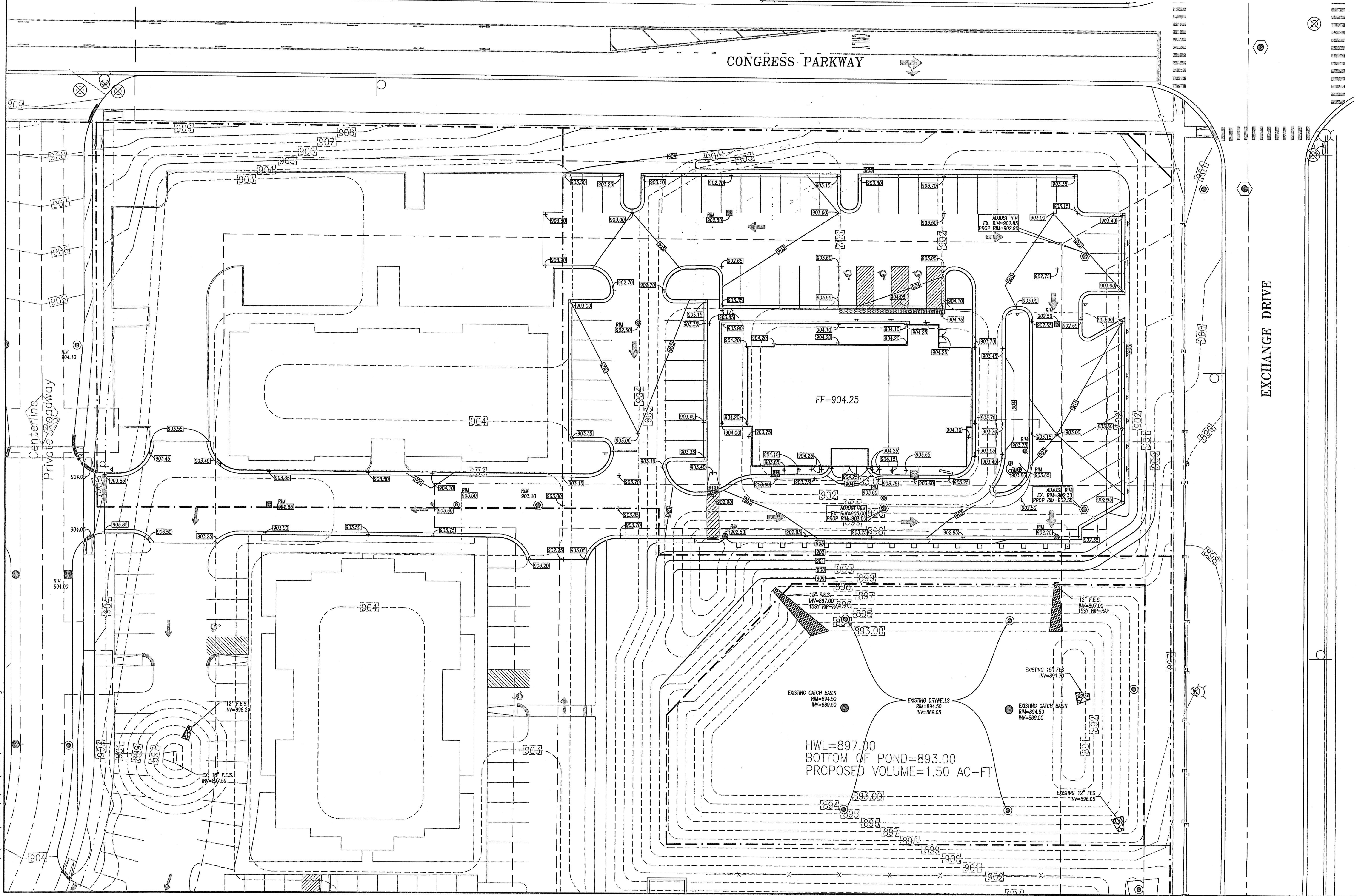
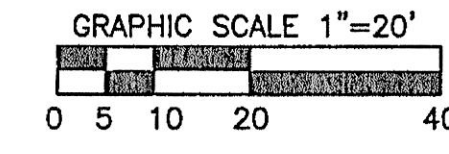

HWL=897.00
 BOTTOM OF POND=893.00
 PROPOSED VOLUME=1.50 AC-FT

No.	Description	Date
3	CITY COMMENTS	02/01/08
2	CITY COMMENTS	12/07/07
1	CITY COMMENTS	10/25/07
	ISSUED FOR PERMIT	09/07/07
	ISSUED FOR PERMIT	08/28/07

GRADING PLAN
 AL & JOE'S RESTAURANT
 PARTNERS IN DESIGN
 CRYSTAL LAKE, IL

JACOB & HEFNER ASSOCIATES, INC.
 ENGINEERS • SURVEYORS
 1901 S. MEYERS ROAD, SUITE 360
 OAKBROOK TERRACE, IL 60161
 PHONE: (630) 662-4600
 FAX: (630) 662-4601

1"=20'
 D605f
 C2.0

H:\D605\D605\FINAL\DWG\FINAL_D605f-Sheets.dwg